

Broomgrove Infant & Junior School

Double Classroom Building

 **Client:** Essex County Council

 **Sector:** Education

 **Location:** Wivenhoe, Colchester, Essex

The Brief

Essex County Council required a permanent modular classroom building at Broomgrove Infant & Junior School to replace an ageing classroom block. The project involved the demolition of the existing building before the installation of a new facility, providing two modern teaching spaces and supporting welfare accommodation for both infant and junior pupils.

Delivered within a live school environment, the project required careful planning to safely undertake demolition, construction and installation while minimising disruption to pupils, staff and day-to-day school activities. Elite Systems delivered a complete turnkey solution, including demolition, design, manufacture, groundworks, installation and commissioning, creating a high-quality, energy-efficient learning environment ready for the new academic year.

 **Project:** Double Classroom Building

 **Location:** Wivenhoe, Colchester, Essex

 **Project Cost:** £619,824.30

 **Timeline:** 12 weeks from site commencement to completion

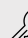
 **Key Features:** Two classrooms, accessible WC, pupil WCs, stores, demolition of existing classroom building, timber feature cladding, level access, external works and energy-efficient construction.

The Main Features

Inside

- ✓ **Modern Teaching Spaces-** Two spacious classrooms designed to provide bright, flexible learning environments for infant and junior pupils.
- ✓ **Integrated Classroom Facilities-** Teaching walls, interactive display provision, fitted storage, sinks and durable worktops support modern teaching methods.
- ✓ **Accessible Welfare Facilities-** An accessible WC together with dedicated pupil toilet facilities provides inclusive accommodation for all building users.
- ✓ **Comfortable Learning Environment-** LED lighting, acoustic ceilings, efficient heating and ventilation create a comfortable environment throughout the year.
- ✓ **Durable Internal Finishes-** Hard-wearing flooring, hygienic wall finishes and robust fixtures have been selected to withstand the demands of a busy primary school.



Outside

- ✓ **Contemporary Appearance-** Blue steel cladding with vertical timber feature panels creates an attractive building that complements the existing school campus.
- ✓ **Safe External Access-** New level-access pathways and external paving provide safe access for pupils, staff and visitors.
- ✓ **Energy-Efficient Construction-** A highly insulated building envelope helps reduce energy consumption while maintaining a comfortable internal environment.
- ✓ **Low Maintenance Materials-** Durable external finishes provide long-term performance while reducing future maintenance requirements.
- ✓ **Integrated External Works-** New tarmac surfacing, drainage and landscaping seamlessly connect the new building to the existing school.

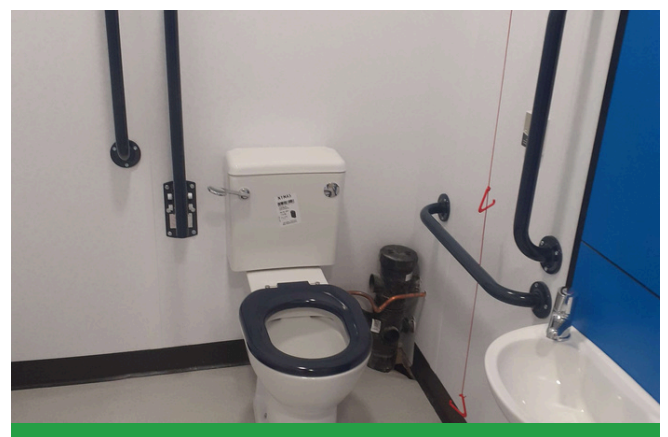

Challenges

Constructing a new teaching facility within a live school environment required careful planning, coordination and phased delivery to ensure the project was completed safely and on programme.



Demolition Within a Live School

The project began with the careful demolition of the existing classroom building before construction of the new facility could commence. Works were carefully planned and sequenced to maintain a safe environment for pupils, staff and visitors, while minimising disruption to teaching and ensuring the programme remained on schedule.



Maintaining School Operations

As the school remained fully operational throughout the project, strict site segregation, controlled access routes and carefully planned deliveries were implemented. Close communication with the school ensured construction activities were coordinated around the school day, allowing education to continue safely with minimal disruption.



Programme Delivery

To meet the required completion date ahead of the new academic year, off-site manufacture was undertaken alongside demolition and groundworks. This parallel approach reduced the overall construction programme, improved efficiency and enabled the building to be installed and commissioned within the client's timescales.



Modern Learning Environments

The new facility was designed to provide bright, flexible classrooms that support modern teaching methods. Careful space planning allowed the inclusion of integrated storage, teaching walls, accessible welfare facilities and services while creating comfortable, engaging learning environments for both infant and junior pupils.



Accessibility & Compliance

The building was designed to fully comply with current Building Regulations and education design standards. Level thresholds, accessible WC facilities, compliant circulation routes and inclusive layouts ensure the building provides safe, comfortable access for pupils, staff and visitors of all abilities.



Quality & Long-Term Performance

A combination of factory-controlled manufacture, robust construction materials and energy-efficient design has created a durable, low-maintenance building capable of meeting the demands of a busy primary school. The completed facility provides Essex County Council with a long-term educational asset that will serve future generations of learners.

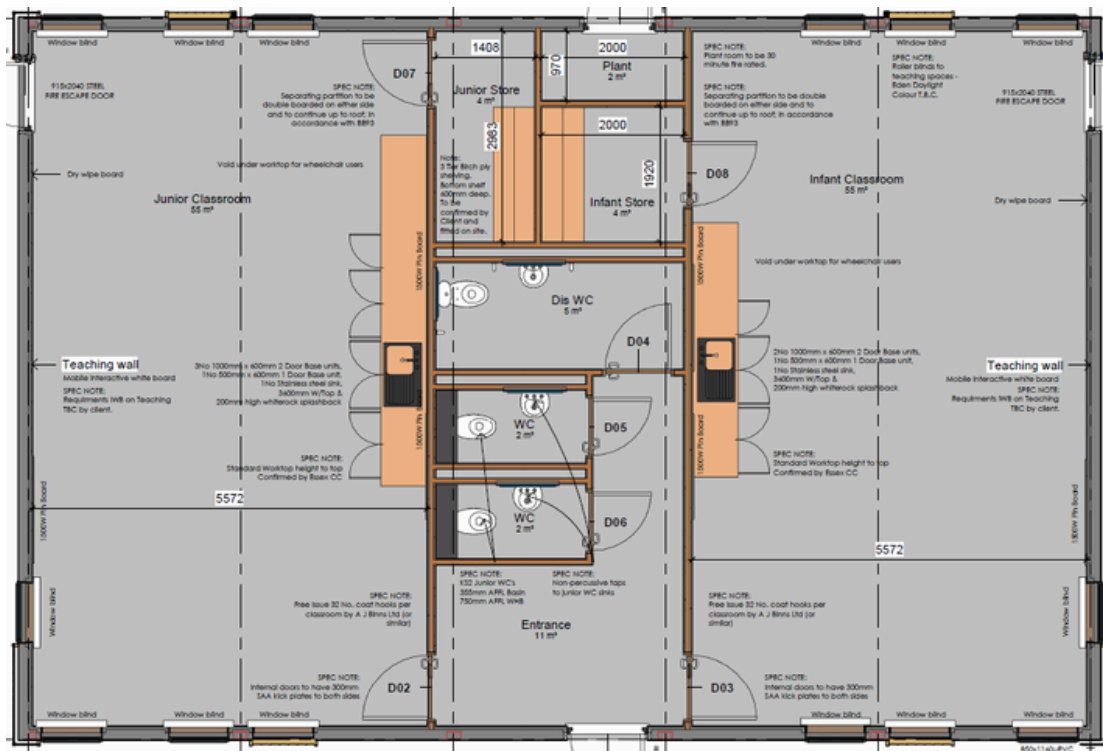

The Design



The new classroom building was designed to create modern, flexible teaching spaces that support both infant and junior education. Large windows maximise natural daylight, while the open classroom layouts, integrated storage and accessible facilities create bright, inclusive learning environments that can easily adapt to changing teaching requirements.

Education Design Features

- ✓ Two 55m² classrooms
- ✓ Dedicated infant and junior stores
- ✓ Accessible WC and pupil toilets
- ✓ Integrated teaching walls
- ✓ Flexible classroom layouts
- ✓ Sink and worktop facilities
- ✓ Level access throughout

Architectural Features

- ✓ Western Red Cedar feature cladding
- ✓ Anthracite aluminium windows & doors
- ✓ Highly insulated building fabric
- ✓ Acoustic ceiling system
- ✓ Energy-efficient LED lighting
- ✓ Durable internal finishes

BEFORE



AFTER

The Results

The completed modular classroom building has provided Broomgrove Infant & Junior School with two modern, permanent teaching spaces that significantly enhance the learning environment for both pupils and staff. Following the demolition of the existing classroom block, the new facility delivers bright, flexible classrooms, accessible welfare facilities and durable finishes designed to meet the demands of everyday school life.

Delivered using off-site modular construction, the project combined demolition, manufacture and installation within an efficient programme, minimising disruption to the operational school. The result is a high-quality, energy-efficient building that provides Essex County Council with a long-term educational facility designed to support future generations of learners.